

Shielded Deep Groove Ball Bearings

NACHI

ZE Shield



- L-Shaped Shield Plate
- U-Shaped Seal Groove

Advanced Shield Design Provides Superior Protection and Quiet Operation

The shield design was optimized using finite element analysis and dynamic analysis modeling techniques. The design profile and plate thickness provides rigidity that helps quiet operation as well as retain grease and protect against intrusion of major contamination.

- Superior in Sealing Out Contamination
- Superb Grease Retention
- Quiet Operation

The Best Components Yield the Greatest Bearing Performance

Rings and balls made of select material have superbly controlled accuracy such as roundness, contour, surface finish, and hardness to provide quieter operation, reduced vibration levels, and long life.

Rivet-type pressed steel cages for strength and durability.

High-performance grease for long life and low noise.

Comparison Test Results

Nachi vs. Other Brands

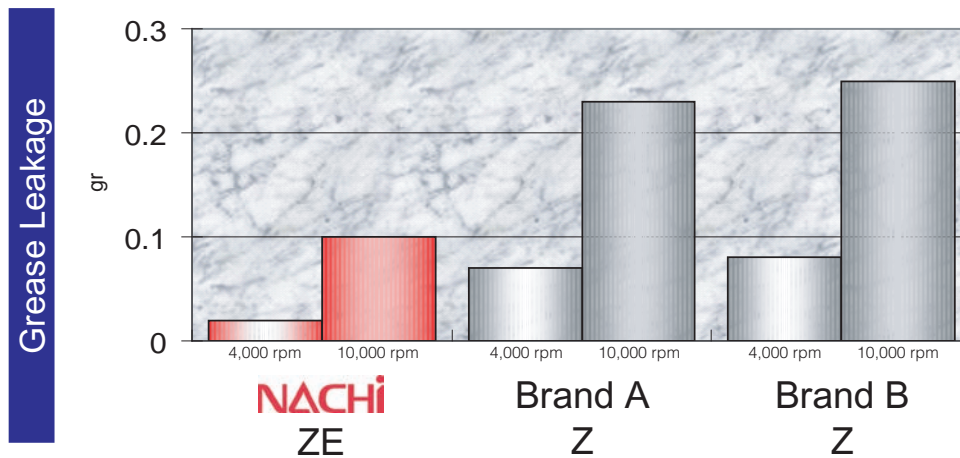

Tested Bearing: 6203ZZE
Inner Ring Rotation, No Load
Ambient Temperature = 80 °C
Test Duration = 20 hours

NACHI ZE shield showed the best performance for retaining grease under both conditions.

Design Comparison

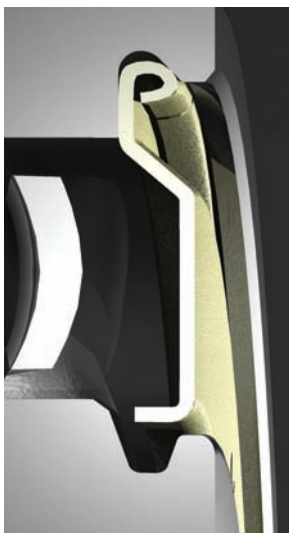

NACHI
ZE



Brand A
Z

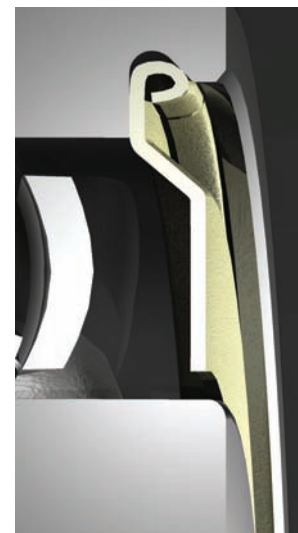

Brand B
Z

Offices

NACHI AMERICA, INC.
Corporate Headquarters
715 Pushville Road
Greenwood, Indiana 46143
Phone: 317-530-1001
Fax: 317-530-1011

WEST COAST BRANCH
12652 Alondra Boulevard
Cerritos, CA 90703
Phone: 800-548-3903
Fax: 562-802-2455

NACHI MEXICANA SA DE CV
Tequisquiapan 2, Aerotech
Industrial Park, Colón, Querétaro
CP 76295
Phone: +52 442 153 2424
www.nachi.com.mx

ENGINEERING LABORATORY
Nachi Technical Center
715 Pushville Road
Greenwood, IN 46143
Phone: 317-530-1008
Fax: 317-530-1012

NACHI
NACHI AMERICA INC.

CATALOG NO.: NMX-2020-IV-05

Mayo 2020