

Sealed Deep Groove Ball Bearings

NACHI

NSE Seal

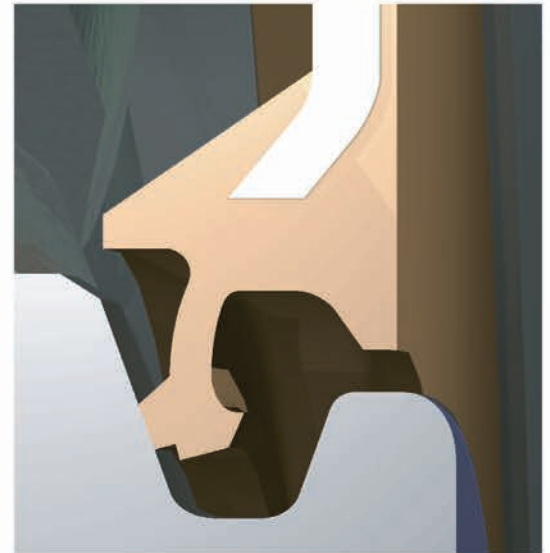

- Triple Seal Lips
- U-Shape Seal Groove
- Breathing Mechanism *
(on seal O.D.)

Advanced Seal Design Provides Excellent Protection and Smooth Operation

The combination of a unique lip design and seal groove provides a labyrinth and steady seal contact.

Breathing mechanism avoids torque increases caused by internal pressure variation due to changes in operating temperatures.

NSE seals allow NACHI bearings to have constant smooth operation and long service life.

- Superior in Sealing Out Dust, Dirt, and Contamination
- Superb Grease Retention
- Light Torque

The Best Components Yield the Greatest Bearing Performance

Rings and balls made of select material have superbly controlled accuracy such as roundness, contour, surface finish, and hardness to provide quieter operation, reduced vibration levels, and long life.

Rivet-type pressed steel cages for strength and durability.

High-performance grease for long life and low noise.

Note : * Non-breather type seals are available for applications in severe water contact environments.

Comparison Test Results

Nachi vs. Other Brands

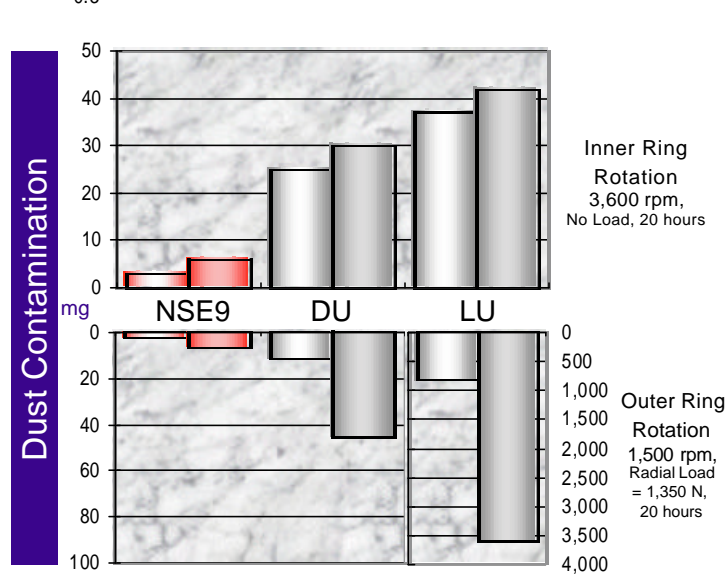
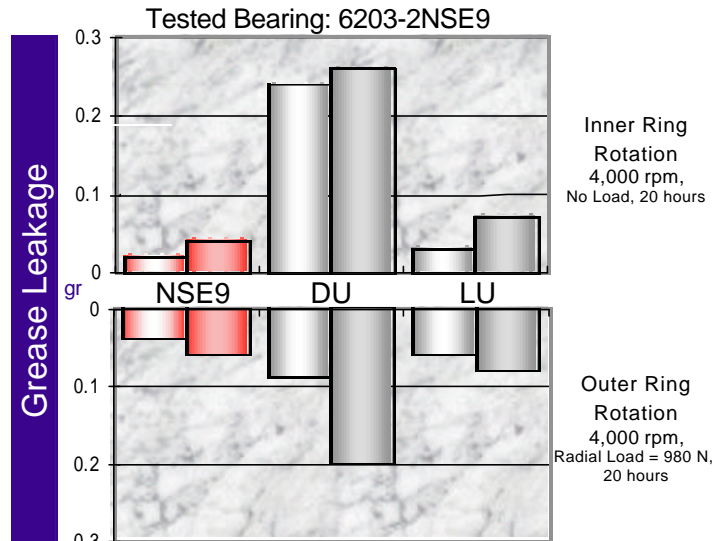
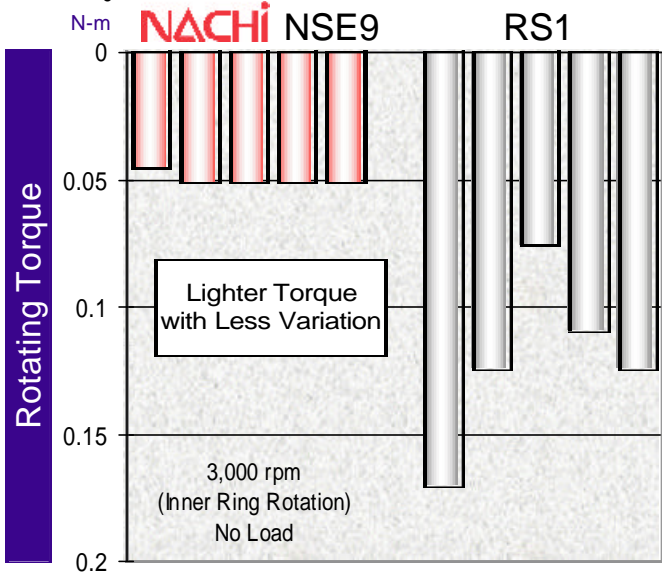
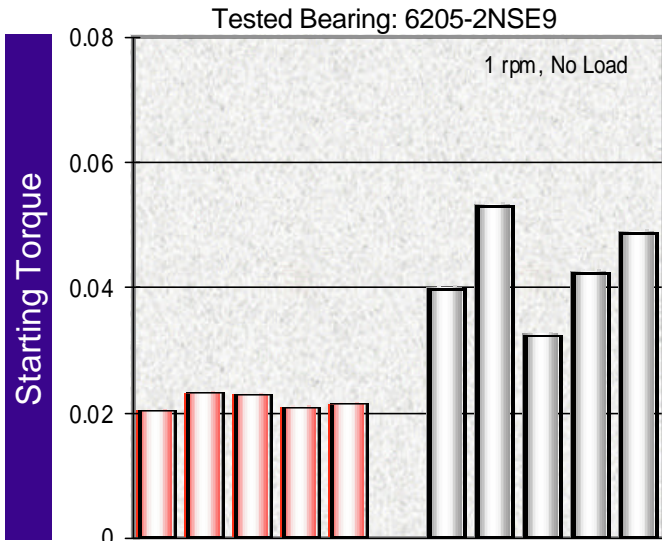

With **NACHI NSE9** Sealed Bearings, **more than 20W of energy can be saved** per bearing at 3,000 rpm.

NACHI NSE9 Seals showed the best performance for retaining grease and avoiding the entrance of dust in these conditions.

Offices

NACHI AMERICA, INC.
Corporate Headquarters
715 Pushville Road
Greenwood, IN 46143
Phone: 317-530-1001
Fax: 317-530-1011

NACHI MEXICANA SA DE CV
Tequisquiapan 2, Aerotech
Industrial Park, Colón, Querétaro
CP 76295
Phone: +52 442 153 2424
www.nachi.com.mx

WEST COAST OFFICE
12652 Alondra Boulevard
Cerritos, CA 90703
Phone: 800-548-3903
Fax: 562-802-2455

ENGINEERING LABORATORY
Nachi Technical Center
715 Pushville Road
Greenwood, IN 46143
Phone: 317-530-1008
Fax: 317-530-1012

